

# Moen Lake Chain

# Moen Lake Chain

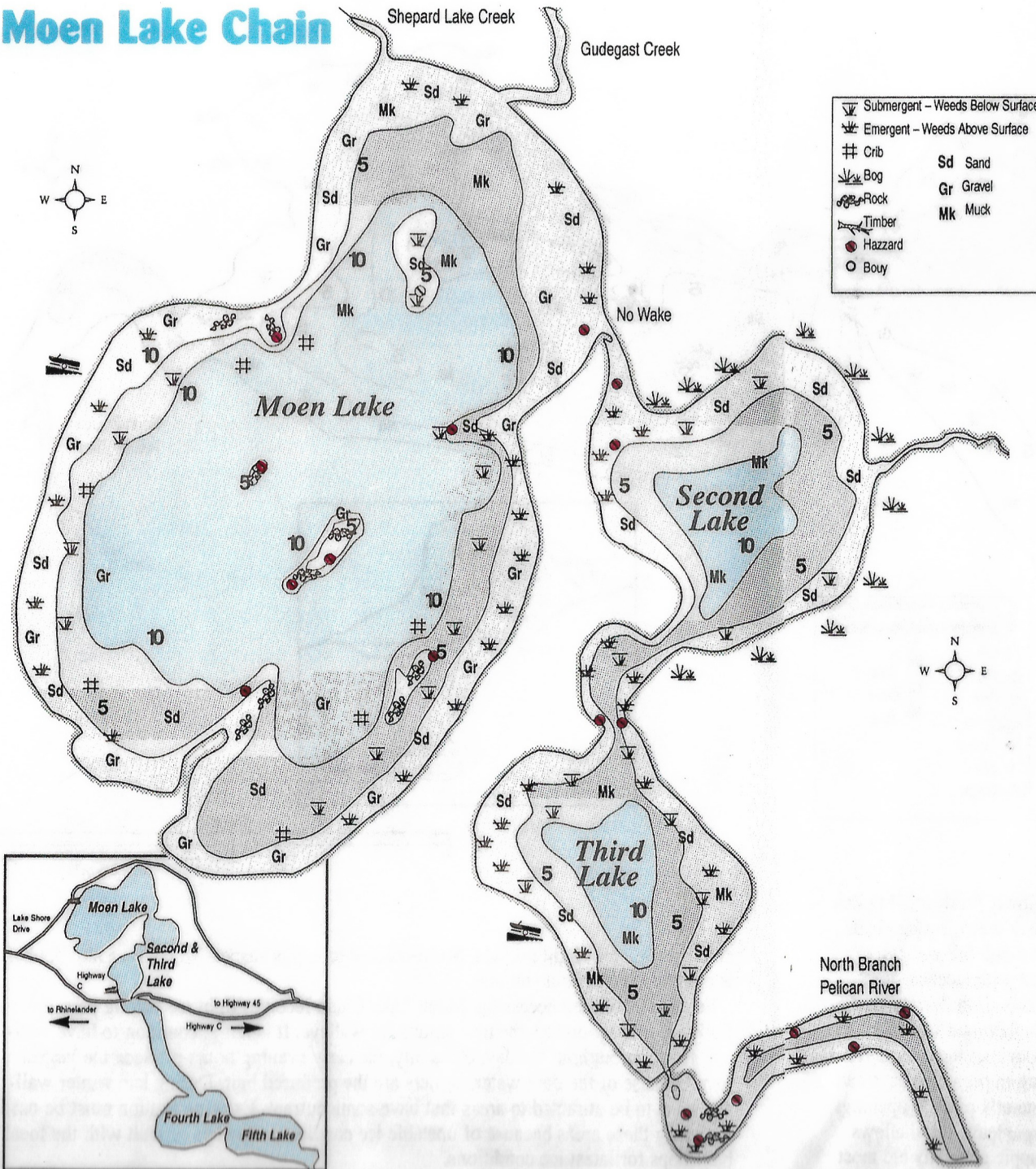

	Submergent - Weeds Below Surface	<b>Sd</b>	Sand
	Emergent - Weeds Above Surface	<b>Gr</b>	Gravel
	Crib	<b>Mk</b>	Muck
	Bog		
	Rock		
	Timber		
	Hazzard		
	Bouy		

**MOEN LAKE**  
460 acres, maximum depth 11 feet

**SECOND LAKE**  
111 acres, maximum depth 11 feet

**THIRD LAKE**  
103 acres, maximum depth 14 feet

**FOURTH LAKE**  
258 acres, maximum depth 9 feet

**FIFTH LAKE**  
240 acres, maximum depth 15 feet

Species	Present	Common	Abundant
Muskie			
Northern Pike			
Walleye			
Largemouth Bass			
Smallmouth Bass			
Crappie			
Perch			
Bluegill			

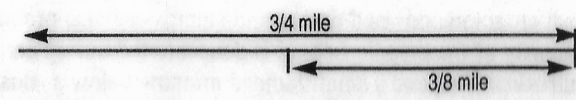
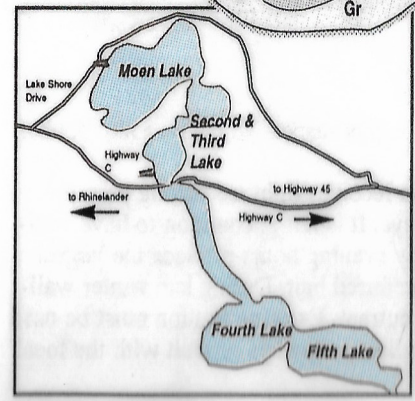



# Moen Lake Chain

# Moen Lake Chain

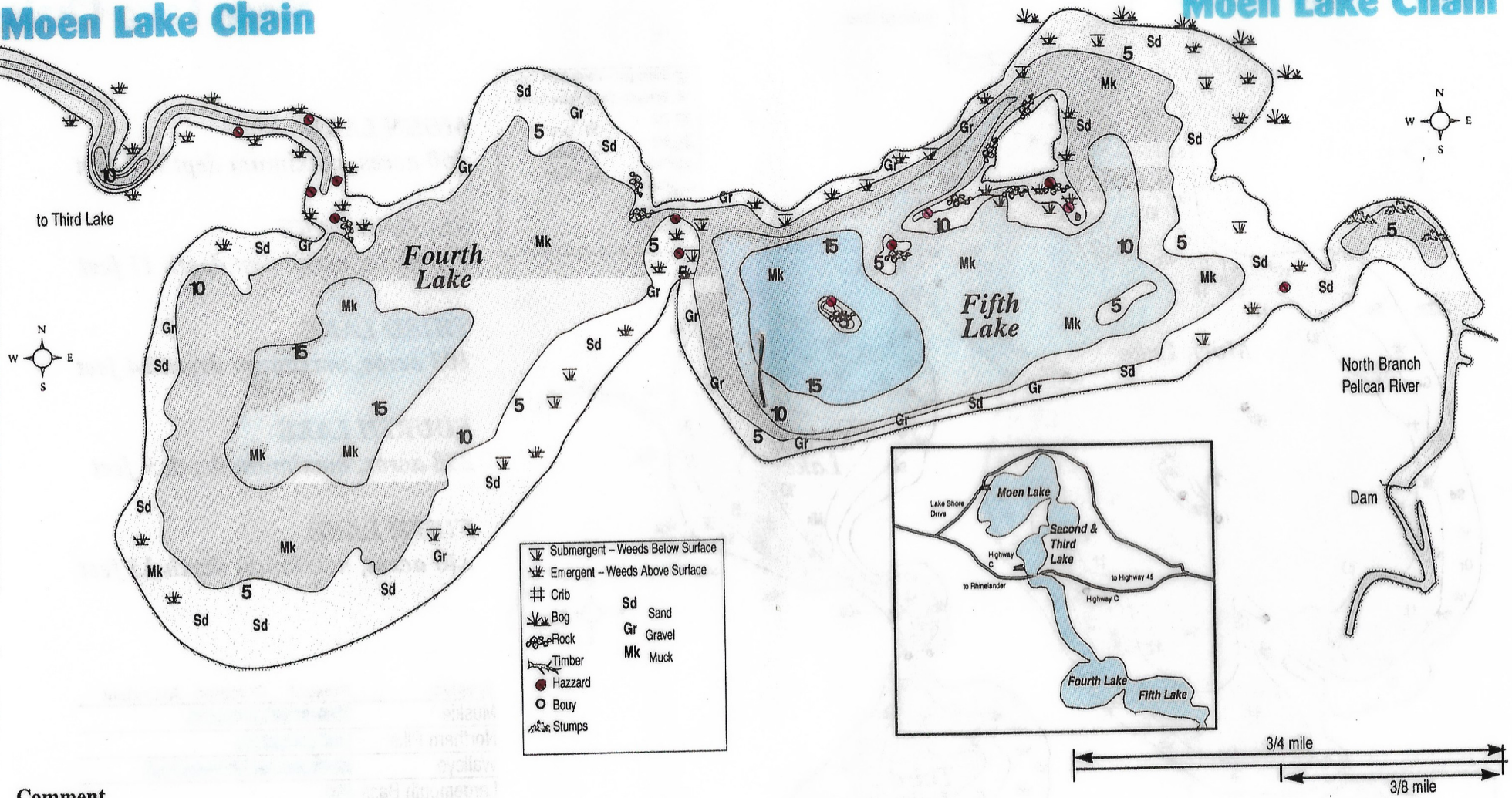

## Comment

The shallow weed flats hold active muskie on opening day. Slowly work small twitch baits or in-line spinners through the shallows. Because of the dark water, surface baits and brightly colored bucktails are suggested. From late spring through fall walleye can be taken from the edges of the available weed growth. Jigs tipped with leeches, night-crawler pieces or minnows should be pitched into the weed pockets. Concentrate on the windward side of the lake with deep-diving crankbaits and jig and Twister Tail combos. Fish attractors, downed timber and stumps can also produce throughout the season. A majority of the crappie fishing is concentrated during early spring in protected bays and bulrushes. Suspend a small fathead minnow below a float and quietly pitch to openings in the available cover. After spawning has been completed, crappie leave the shallows and suspend around fish cribs, rock humps and weed edges. Crappie generally are most

active during low-light periods. Multi-colored tube jigs suspended below a slip bobber is effective throughout summer.

Because of limited access the Moen Lake Chain receives light ice fishing pressure. Early ice often produces the best results for walleye. It is not uncommon to have walleye action throughout the day. Generally, the early evening hours produce the largest fish. Because of the dark water, shiners are the preferred bait. During late winter walleye seem to be attracted to areas that have some current. Extreme caution must be used in fishing these areas because of unstable ice conditions. Always consult with the local bait shops for latest ice conditions.